



Cavendish House, Haverhill, CB9 8JY

**CHEFFINS**

## Cavendish House

Haverhill,  
CB9 8JY

A spacious two bedroom first floor apartment conveniently located close to the town centre and amenities. The property benefits from secured entry and allocated off road parking. Available 22nd May 2026.

- Two Bedrooms
- Lounge Dining Room
- Kitchen
- Bathroom
- EPC Rating B
- Council Tax Band B



**£950 Per Month**



**Entrance Hall**

Storage cupboard housing hot water cylinder, doors to:

**Lounge/Dining Room**

Two windows, opening to:

**Kitchen**

Fitted wall and base units with worktop over, sink with mixer tap and drainer, electric oven and hob, space and plumbing for appliances

**Bedroom One**

Window

**Bedroom Two**

Window

**Bathroom**

Panelled bath with shower over, wc, wash hand basin

**Parking**

Allocated parking space in gated communal car park to rear of building

**Material Information**

£219.00

**Material Information**

For more information on this property please refer to the Material Information brochure on our Website



## Ground Floor

Approx. 57.9 sq. metres (623.4 sq. feet)

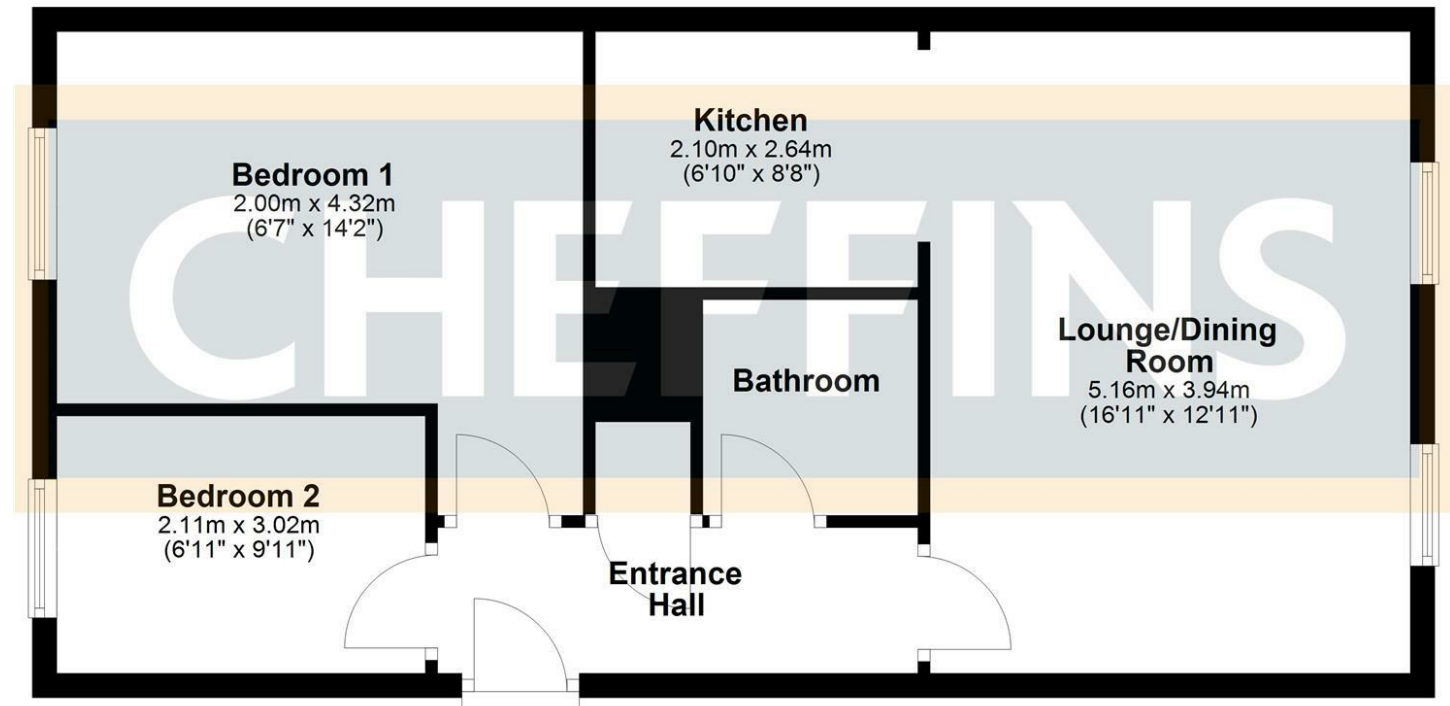

Total area: approx. 57.9 sq. metres (623.4 sq. feet)

### Energy Efficiency Rating

	Current	Potential
Very energy efficient - lower running costs		
(92 plus) <b>A</b>		
(81-91) <b>B</b>	<b>82</b>	<b>84</b>
(69-80) <b>C</b>		
(55-68) <b>D</b>		
(39-54) <b>E</b>		
(21-38) <b>F</b>		
(1-20) <b>G</b>		
Not energy efficient - higher running costs		
<b>England &amp; Wales</b>	EU Directive 2002/91/EC	

### Agents note:

For more information on this property please refer to the Material Information Brochure on our website.

Cavendish House, 27a High Street, Haverhill, Suffolk, CB9 8AD | 01440 707076 | cheffins.co.uk



IMPORTANT: we would like to inform prospective purchasers that these sales particulars have been prepared as a general guide only. A detailed survey has not been carried out, nor the services, appliances and fittings tested. Room sizes should not be relied upon for furnishing purposes and are approximate. If floor plans are included, they are for guidance only and illustration purposes only and may not be to scale. If there are any important matters likely to affect your decision to buy, please contact us before viewing the property.